

FreeDebks

1.0.3

Generated by Doxygen 1.8.1.2

Thu Dec 6 2012 16:57:19

Contents

1	FreeDebks documentation in English	1
2	Create a new accounting	3
2.1	Create the chart of accounts	3
2.2	Create a results list	4
3	Write entries	5
4	Create a new year	7
5	Print	9

Chapter 1

FreeDebks documentation in English

Welcom in the English version of FreeDebks documentation. It will help you mastering this software.

FreeDebks is a double entry accounting application. You must be familiar with the basics of accounting in order to use it.

The documentation contains the following chapters :

- [Create a new accounting](#)
- [Write entries](#)
- [Create a new year](#)
- [Print](#)

Chapter 2

Create a new accounting

Once FreeDebks is loaded, you may want to create a new accounting through **File >> New...**

A window like this one will pop up :

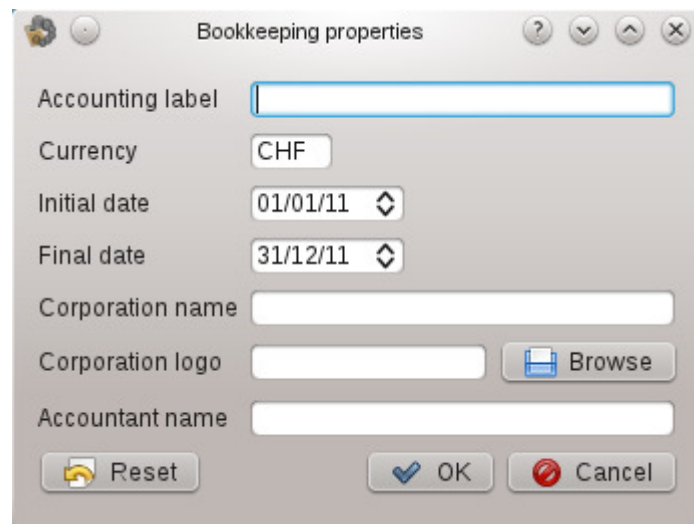

The image shows a 'Bookkeeping properties' dialog box with the following fields and controls:

- Accounting label: A text input field.
- Currency: A dropdown menu showing 'CHF'.
- Initial date: A date picker showing '01/01/11'.
- Final date: A date picker showing '31/12/11'.
- Corporation name: A text input field.
- Corporation logo: A text input field and a 'Browse' button.
- Accountant name: A text input field.
- Buttons: 'Reset', 'OK', and 'Cancel'.

Figure 2.1: New accounting window

Remark The first field has to be fulfilled.

The *Logo* field supports absolute or relative (to the accounting file storing place) path. The logo will be displayed on top of pages while [printing](#). There is no size restriction ; FreeDebks will rescale the picture.

When all fields are set, click on *Ok*. A field backgrounded in red is incorrect. It can be on of the following errors :

- the label is missing,
- min and max dates are incoherent.

When the new accounting is created, you can directly save it.

2.1 Create the chart of accounts

You should see three tabs. Click on **Chart of accounts** and click on **Edit >> Add line**. By default, the new item is an account.

You distinguish to types of items in the chart of accounts :

- **Categories** : an item becomes a category from the moment it gets a child item, another category or an account. The number of level in the tree is not limited. Categories appear in bold.
- **Account** : an account is an item with no child. Only accounts can be used to [write entries](#). **Remark** If an account is used in a category, it can't anymore become a category.

Each line of the chart of accounts (category or account) contains :

- **Id** : a unique id. FreeDebks will sort items by id (alphabetically), without modifying the tree structure.
- **Label** : the item label, also unique.
- **On balance sheet** : a check box, to precise wheter or not the element will appear on the accounting balance sheet. This option is used when creating a new year. This option only appears for top level items ; child items will behave like their parent.
- **Signs** : this column only makes sense for accounts. It can have to types :
 1. **+ -** : accounts raises in debit and lowers in credit.
 2. **- +** : accounts lowers in debit and raises in credit.
- **Initial balance** : only for accounts.

Just double-click on the field you want to change.

Trick Type *Page Up* to select the parent of the current item. So, to create an account right after the current on, type **Page Up** then **Ctrl + L**.

2.2 Create a results list

At the next step, you will create a list of accounting results. Click on result tab, the **Add line** (in the **Edit** menu).

Each line contains the following fields :

- **Id** : a unique id. This id can't be one of the chart of accounts or one of another result line.
- **Label** : the item label. It isn't necessary unique.
- **Calculation** : you have to respect the following rules :
 1. Use only +, -, *, / symbols, as well as parenthesis ().
 2. To use an account, a category or another result, just write the item id between quotes, like "1000".
 3. You can use scalars.

If FreeDebks can't parse the calculation, it will background the corresponding line in red.

You can now use your accounting. Next step : [write entries](#).

Chapter 3

Write entries

Click on **Journal** tab, the **Edit >> Add line**. An entry contains the following fields :

- **Date** : the entry date, must be between min and max dates set while [creating a new accounting](#).
- **Object** : a physical proof of the entry. It is not necessary to fill this field.
- **Label** : the entry label. FreeDebks uses labels to match similar entries and help user to quickly write repeated operations.
- **Debit** : you have to fill either this or the next field. FreeDebks will help you complete the account id.
- **Debit account** : debit account label. You can fill this field by writing either an account id or a label.
- **Credit** : behaves like *Debit*.
- **Credit account** : behaves like *Debit account*.
- **Amount** : the entry amount.

When entries are written, you can dispatch them into accounts with the command **Accounting >> Recompute all**.

Next step : [Create a new year](#).

Chapter 4

Create a new year

When year has ended, you can create a new accounting through **Accounting >> Create a new year**. FreeDebks will create a new year, copying balances for accounts with *On balance sheet* set (see [Create the chart of accounts](#)).

Chapter 5

Print

File >> Print. Select the printer and click **Print**. You will see the following menu :

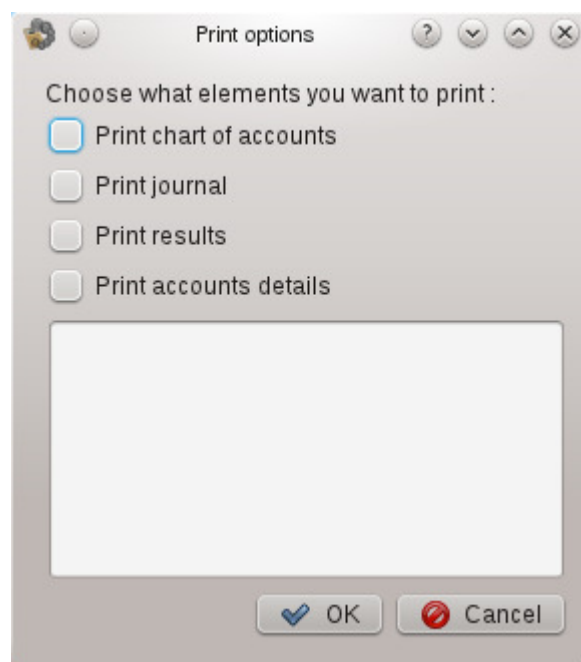

Figure 5.1: Printing selection

You can select one by one items you want to print. If you check the last box, you can print accounts details.

Remakr Only accounts with entries will be printed.